

# ROB40202 à 12

## TECHNICAL DATA

**Valvola a sfera a passaggio ridotto FXF con leva (con farfalla art. 1000 T)**  
**Reduce way ball valve FXF with lever (with butterfly handle art. 1000 T)**

CARATTERISTICHE	FEATURES
<ul style="list-style-type: none"> <li>CORPO, SFERA E ASTA IN OTTONE P-OT 58 Pb 2 UNI 5705-65.</li> <li>SFERA LAVORATA CON UTENSILE IN DIAMANTE, NICHELATA E CROMATA.</li> <li>SEDI IN P.T.F.E. VERGINE DIMENSIONATE CON ANGOLO DI TENUTA DI 7° MIN.</li> <li>GUARNIZIONE TENUTA ASTA: O-R IN GOMMA NBR</li> <li>LEVA DI COMANDO IN ACCIAIO IMBUTITO VERNICIATA CON RESINA EPOSSIDICA ROSSA.</li> <li>FINITURA SUPERFICIALE SABBIAIA NICHELATA</li> <li>FILETTATURE ISO 228/1</li> </ul>	<ul style="list-style-type: none"> <li>BRASS "P-OT 58 Pb 2 UNI 5705-65" BODY, BALL STEM.</li> <li>BALL GROUND BY DIAMOND-TIPPED TOOL, NICKEL AND CHROMIUM PLATED.</li> <li>VIRGIN P.T.F.E. SEATS WITH 7° MIN. TIGHTNESS ANGLE.</li> <li>O-RING STEM PACKING IN NBR RUBBER.</li> <li>STEEL SHAPED LEVER WITH RED PLASTIC COATING.</li> <li>NICHEL PLATE FINISHING.</li> <li>THREADING TO ISO 228/1.</li> </ul>

### DIMENSIONI PRINCIPALI

### LEADING DIMENSIONS

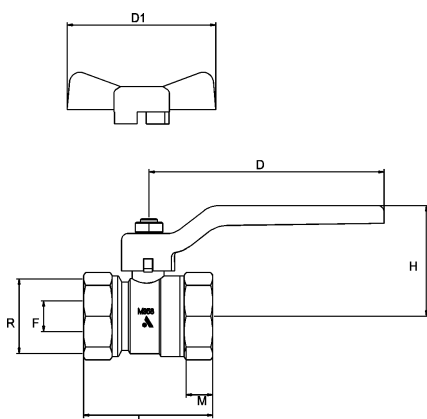

R"	1/4	3/8	1/2	3/4	1	1 ¼	1 ½	2	2½	3	4
D			85	85	115	115	158	158	173	237	237
D1			54	54	70	-	-	-			
H			46	50.5	57	66	73	79.5	90	125	133
H1			32	36	46	-	-	-			
L			47.5	53	61	67	77.5	89	116	135	158
M			12	14	14.5	15.5	16	17	21	21	23
M1											
F			11	15	19	24	30	40	50	62	70

### PRESSIONI DI ESERCIZIO A MAX 80° C

### WORKING PRESSURES AT 80° C MAX

PN 40											
PN 32											
PN 25			*	*	*	*	*	*	*	*	*
PN 20											
PN 16											
PN 10											
	1/4"	3/8"	1/2"	3/4"	1"	1 ¼"	1 ½"	2"	2 ½"	3"	4"

p.s.i. 600  
 p.s.i. 450  
 p.s.i. 350  
 p.s.i. 300  
 p.s.i. 250  
 p.s.i. 150

### PERDITE DI CARICO

### PRESSURE DROPS

R"	1/4	3/8	1/2	3/4	1	1 ¼	1 ½	2	2 ½	3	4
Kv	-		9	15	30	57	94	160	265	390	525

$$\Delta P \text{ [ mm H}_2\text{O]} = 10.000 \times \left[ \frac{G \text{ [mc/h]}}{Kv} \right]^2$$